

## ONYX® 6" CD / DVD, IC Target, High Rate Magnetics

### US Specifications

#### Construction

|              |                     |
|--------------|---------------------|
| Anode        | 304 Stainless Steel |
| Cathode Body | OFHC Copper         |
| Insulator    | PTFE / CTFE         |

#### Cooling Requirements

|                                    |         |
|------------------------------------|---------|
| Flow Rate at Maximum Power         | 2.5 GPM |
| Maximum Input Pressure, Open Drain | 60 psi  |
| Maximum Input Temperature          | 68 °F   |

#### Dimensions

|   |                 |
|---|-----------------|
| A | Consult Factory |
| B | Consult Factory |

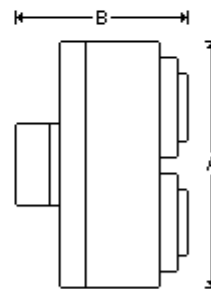

#### General

|                                     |                                |
|-------------------------------------|--------------------------------|
| Magnetic Enhancement                | Permanent (NdFeB) Encapsulated |
| Maximum Temperature                 | 212 °F                         |
| Source to Substrate Distance        | 1.000" - 8.000"                |
| Weight, Approximate Without Options | Consult Factory                |

#### Maximum Sputtering Power \*

|                          |                  |
|--------------------------|------------------|
| Cathode Voltage          | 100 - 1500 Volts |
| Discharge Current        | 20 Amps          |
| Indirect Cooled Mode, DC | 10 kW            |
| Indirect Cooled Mode, RF | Consult Factory  |
| Operating Pressure       | 0.5 - 50 mTorr   |

**Mounting, Standard**

---

|                               |          |
|-------------------------------|----------|
| Cathode Mounting              | Flange   |
| Power Connector, DC           | 7/16 DIN |
| Water, Outer Dimension Tubing | 0.500"   |

---

**Target**

---

|           |                   |
|-----------|-------------------|
| Cooling   | Indirect          |
| Diameter  | 6.000"            |
| Form      | Circular / Planar |
| Thickness | Consult Factory   |

---

**Specifications Disclaimer**

---

- All Angstrom Sciences NdFeB magnets are totally encapsulated and protected from degradation by water.
  - All sources are available in external configurations.
  - \* Maximum power for cathode only, a target material's properties, such as, thermal and electrical conductivity may limit the maximum process power level.
  - Some custom-engineered and specialty magnetrons may not meet standard specifications.
  - Specifications are subject to change without notice.
  - Typical performance. Results may vary with process parameters such as pressure, flow rate, target material, and substrate rotation, etc.
- 

Angstrom Sciences | Call +1-412-469-8466 | [www.angstromsciences.com](http://www.angstromsciences.com)