

## ONYX® 4" High Temperature, Standard Magnetics

### US Specifications

#### Construction

Anode	304 Stainless Steel
Cathode Body	OFHC Copper
Insulator	Ceramic

#### Cooling Requirements

Flow Rate at Maximum Power	0.75 GPM
Maximum Input Pressure, Open Drain	60 psi
Maximum Input Temperature	68 °F

#### Dimensions

A	5.000"
B	4.309"
C	0.750"

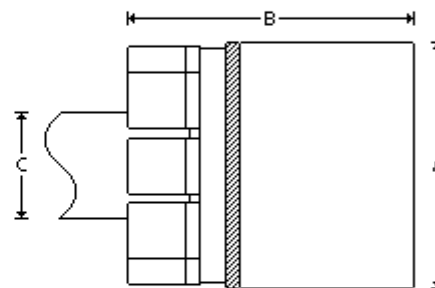

#### General

Magnetic Enhancement	Permanent (NdFeB) Encapsulated
Maximum Temperature	392 °F
Source to Substrate Distance	2.000" - 12.000"
Weight, Approximate Without Options	13 lb

#### Maximum Sputtering Power \*

Cathode Voltage	100 - 1500 Volts
Discharge Current	0.1 - 4 Amps
Indirect Cooled Mode, DC	2 kW
Indirect Cooled Mode, RF	700 Watts
Operating Pressure	1 - 50 mTorr

### Mounting, Standard

---

Power Cable, DC	1675A
Power Cable, RF	1675A
Power Connector, DC	Type N Connector, External Threads
Power Connector, RF	Type HN Connector, External Threads
Stem, Outer Dimension Tubing	0.750"
Water, Outer Dimension Tubing	0.250"

### Target

---

Cooling	Indirect
Diameter	4.000"
Form	Circular / Planar
Thickness	0.060" - 0.375"

### Specifications Disclaimer

---

- All Angstrom Sciences NdFeB magnets are totally encapsulated and protected from degradation by water.
  - All sources are available in external configurations.
  - \* Maximum power for cathode only, a target material's properties, such as, thermal and electrical conductivity may limit the maximum process power level.
  - Some custom-engineered and specialty magnetrons may not meet standard specifications.
  - Specifications are subject to change without notice.
  - Typical performance. Results may vary with process parameters such as pressure, flow rate, target material, and substrate rotation, etc.
- 

Please contact us for specifications regarding your application.

Angstrom Sciences | Call +1-412-469-8466 | [www.angstromsciences.com](http://www.angstromsciences.com)